

TS twin throttle body -

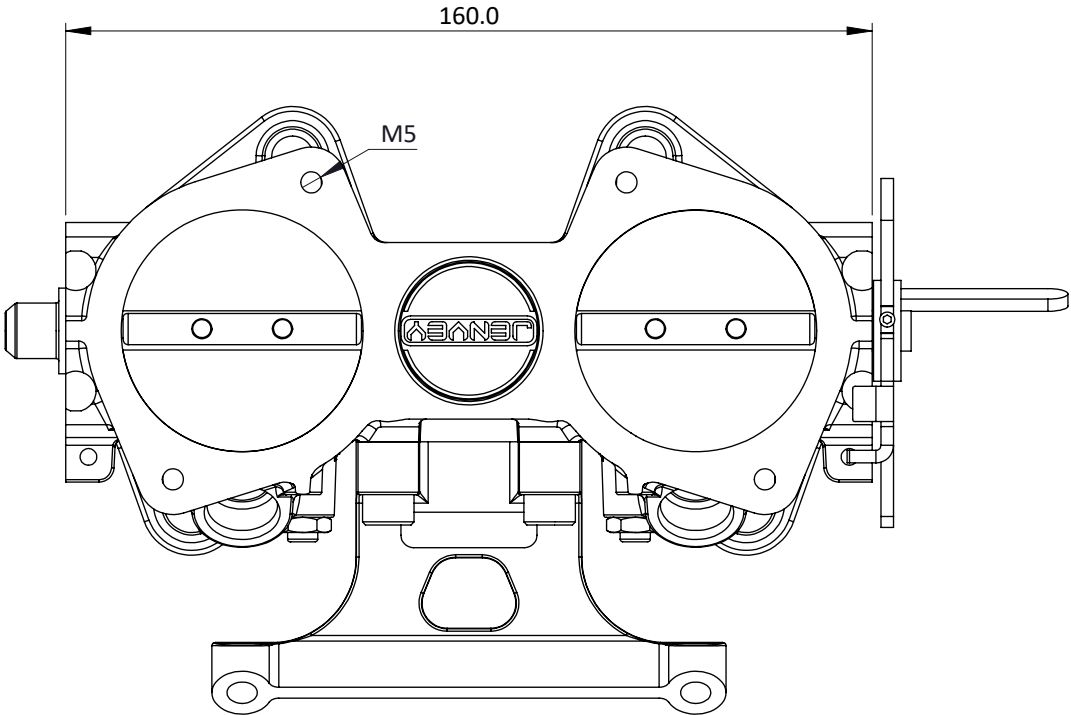

Engineered to win

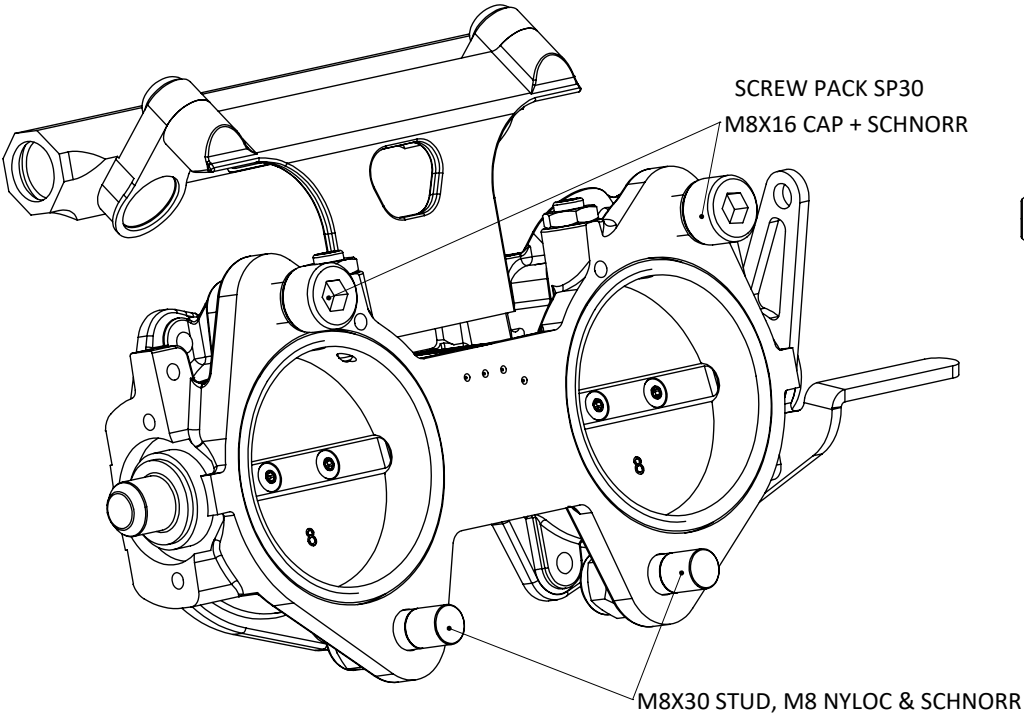

FUEL RAIL MOUNT INCLUDED
FULE RAIL NOT INCLUDED

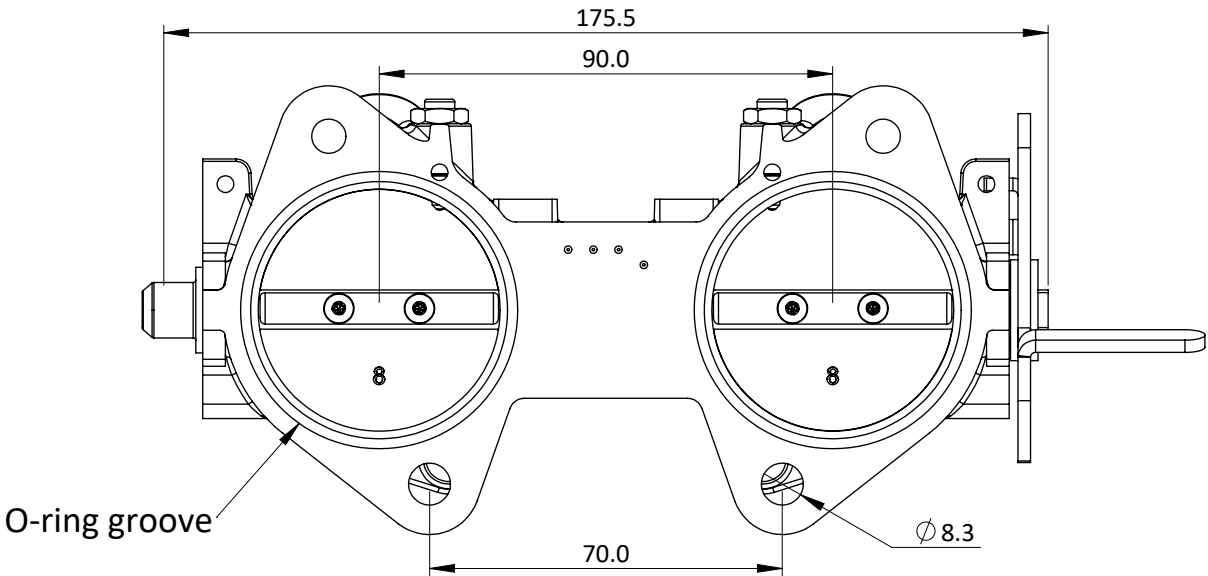
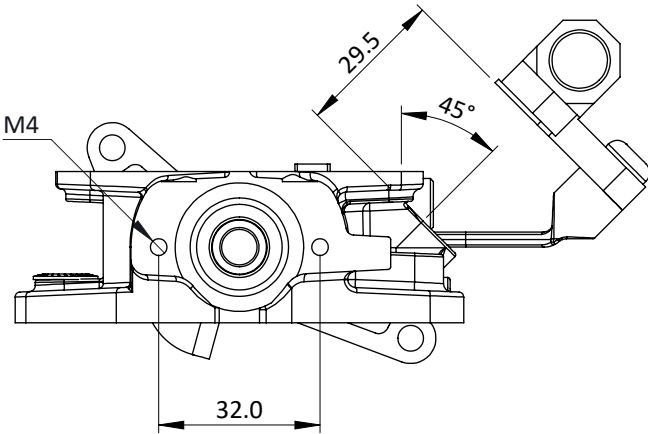
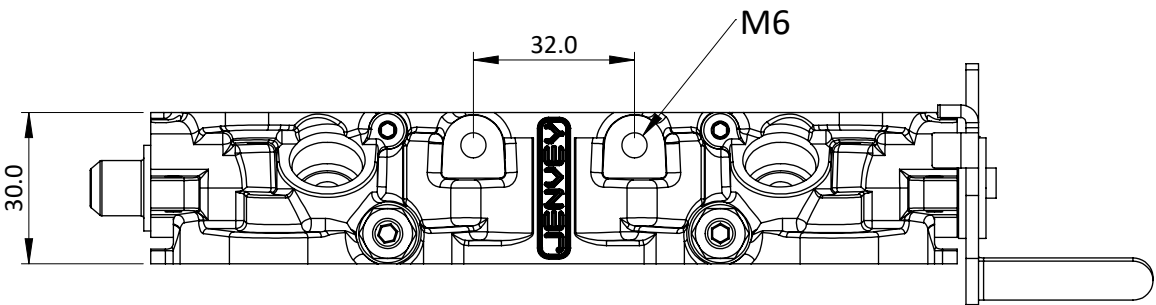
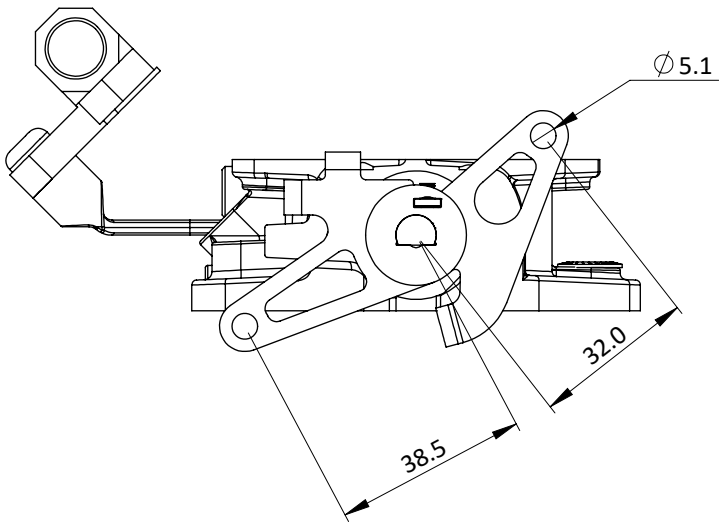
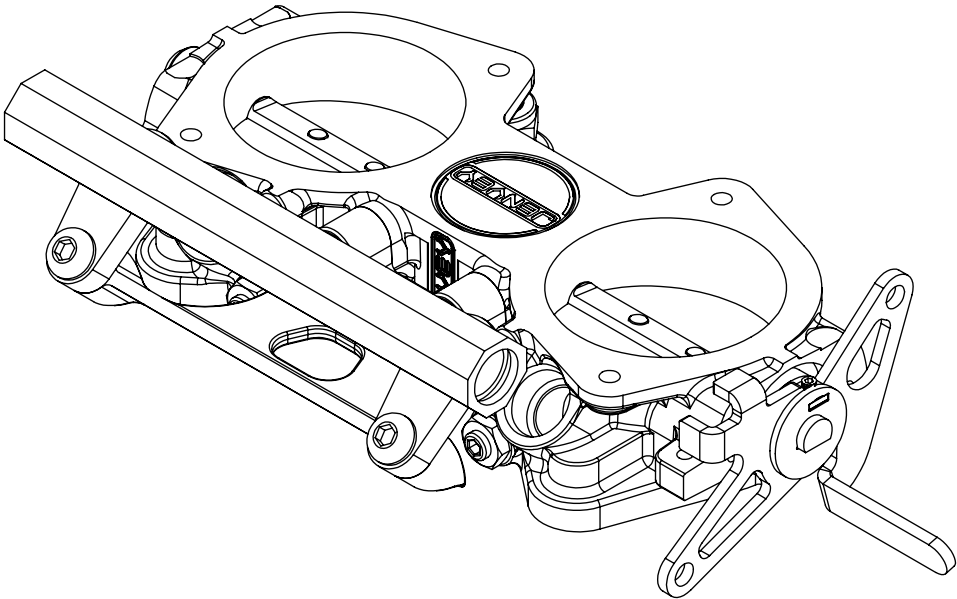

Available in parallel bore TSS40i , TSS42i , TSS45i,
TSS48i and TSS50i mm, measuring 30mm long.
Please note when using our 30mm high bodies, some
modification may be needed to mount an air filter as
the levers may clash.

The type TS body is designed to fit the same flanges as Twin horizontal carborettors from Weber, Dellorto, Solex etc. It is an extremely compact body allowing very long air horns to be used within a given system length. The body comes with idle bypass adjustment, fuel rail mountings (to take any of our twin body rails) and O-rings on the outlet. Operating data; Spindle rotation: 82 degrees. Torque per spindle at WOT: 300-340 N-mm which gives a tangential pull of 8-9 N on long arm of standard lever.

Frame:	1 of 1	
Version:	4	
Tel 01746 768810		© JENVEY DYNAMICS LTD. 2021
Web WWW.JENVEY.CO.UK		